

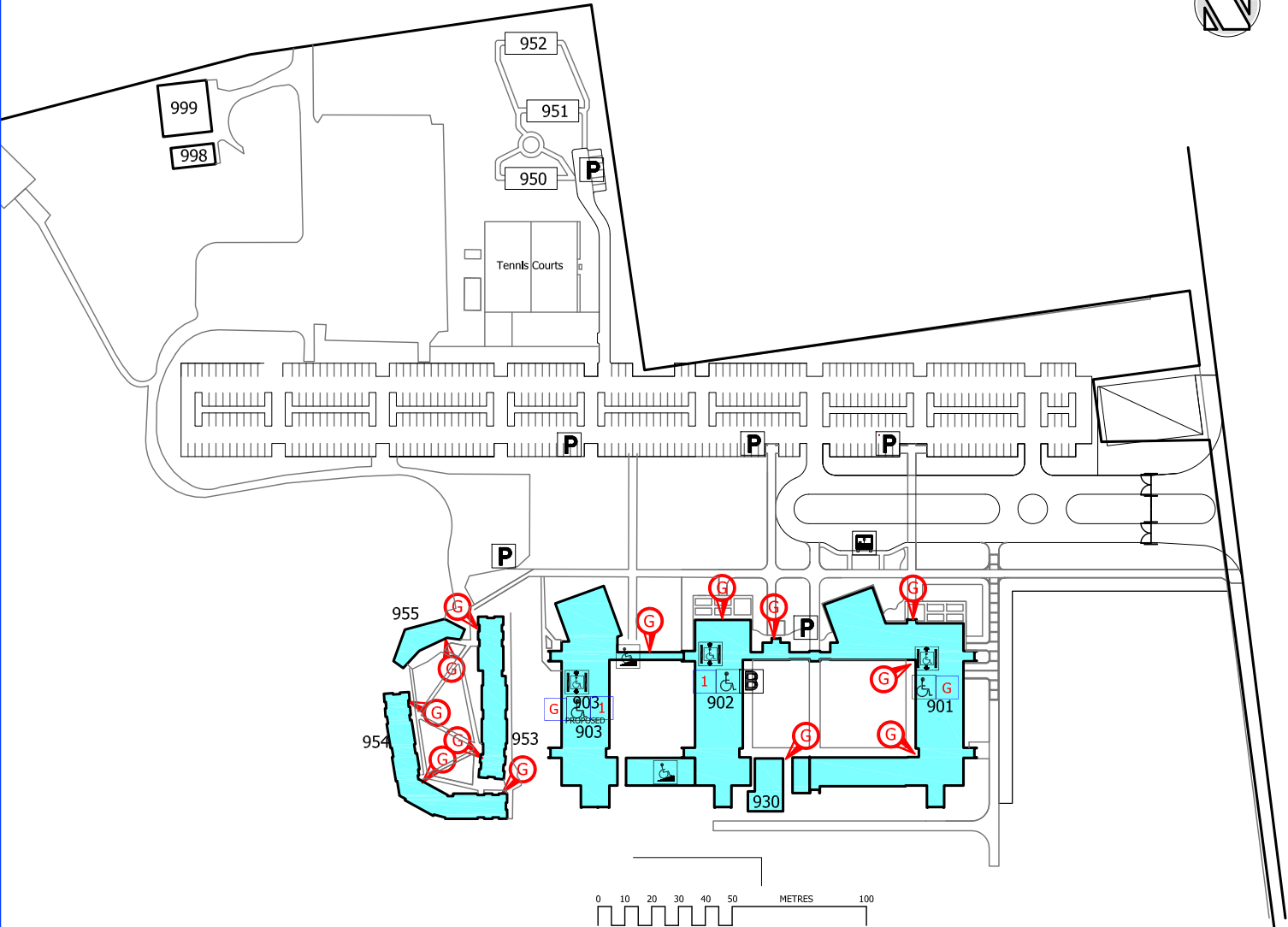

| Building No. | Building Name |
|--------------|-------------------------------------|
| 901 | Multi-discipline Building - Stage 1 |
| 902 | Multi-discipline Building - Stage 2 |
| 903 | Multi-discipline Building - Stage 3 |
| 930 | Facilities Administration |
| 950 | Student Residence - Building 1 |
| 951 | Student Residence - Building 2 |
| 952 | Student Residence - Building 3 |
| 953 | Student Accommodation |
| 954 | Student Accommodation |
| 955 | Student Pavilion |
| 998 | Hanger Garage |
| 999 | Hanger |

LEGEND

-  Accessible Entrance To Level Indicated
-  Disabled Parking
-  Steep Gradient
-  Lift
-  Accessible Toilet
-  Bus Stop
-  Baby Change Facility
-  Access to all levels



MOBILITY MAP